

| 116CP SERIES

WATER PRESSURE SENSOR

Introduction

Utilizing Sensata's industry leading ceramic capacitive technology, the 116CP is housed in a small and innovative plastic package ideal for boilers, pumps, and other light industrial applications.

The 116CP is offered in a wide range of configurations including various pressure ports, electrical outs and pressure ranges from 0-3 to 0-16 bar.



Features

- Multiple port & Connector options
- High accuracy: +/-1.5%FS
- Small & compact size
- 100% automated calibration
- REACH/RoHS compliant

Applications

- Boilers
- Heat pumps
- Residential booster pumps
- Lawn & Pool pumps
- Circulator pumps
- Pump controllers
- Food & Beverage equipment

SPECIFICATIONS

Electrical

Supply Voltage	5VDC or 8-30VDC
Output Voltage	0.5 to 3.5V
Supply Current	8.0mA
Output Current	5.0mA (max)
Output Load	10kOhm pull down
Output Response Time	<10ms
Overvoltage Protection	16V
Reverse Voltage	-14V
Short Circuit Protected	Yes
EMC	Conforms to EN 61326-2-3 for sensors
ESD	8kV/air, 4kV/direct

Pressure Ranges	0-3 to 0-16bar
------------------------	----------------

Physical

Proof Pressure	2xFS ⁽¹⁾
Burst Pressure	3xFS ⁽¹⁾
Random Vibration	5G (2-2kHz)
Mechanical Shock	40G½ HL SINE
Drop (any Axis)	1m

⁽¹⁾ FS (Pressure) = Pmax – Pmin

FS (Voltage) = Voutmax - Voutmin

Performance

Electrical Connection	RAST 2.5
Pressure Connection	G¾, G¼, quick connect (See next page drawings)
Pressure Reference	Sealed Gauge (1bar)
Total Error Band Accuracy	+/-1.5%FS (typical)
Operating Temperature	2° to 90°C
Storage Temperature	-40° to 125°C



DIMENSIONS

Dimensions in mm [Inch]

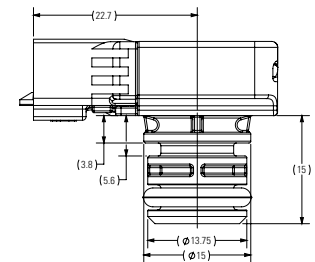
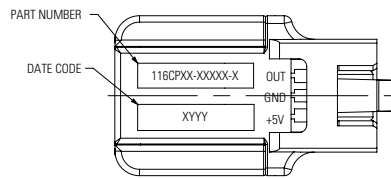
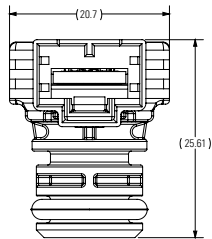

Quick Connect Type 2

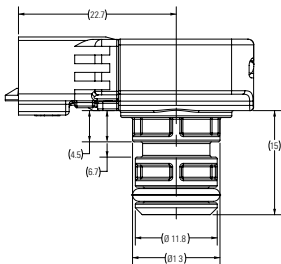

G 1/4

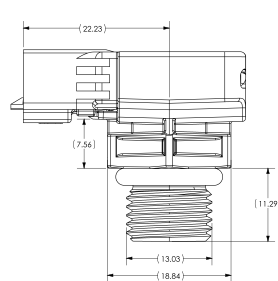

G 3/8

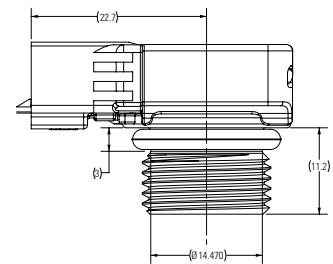



ORDERING OPTIONS

Example : 116CP21-M04S2-0

Input		
116 (5VDC)		
117 (8-30VDC)		
Family		
CP Ceramic Capacitive Pressure (APT)		
Port		
1 (Null)	3 (G ¹ / ₄)	5 (Quick Connect Type 2)
2 (Quick Connect Type 1)	4 (G ³ / ₈)	
Connector		
0 (Null)	2 (RAST 2.5 4Pos)	
1 (RAST 2.5 3Pos)	3 (RAST 2.5 3Pos Alternate)	
Pressure		
Bar PSI	M06 090	M16 230
M04 060	M10 150	MX ^X YYY
P_ref		
A (Absolute)	S (Sealed Gauge)	
G (Gauge)		
Span		
1 (1.125-3.6V)	3 (0.5-4.5V)	5 (0.5-2.5V)
2 (0.5-3.5V)	4 (0.5-2.75V)	6 (Custom)
Special Requirement		
0 or 50 (Application Dependent)		
1 (Custom)		



AGENCY APPROVALS & CERTIFICATIONS

REACH
 RoHS compliant
 CE

Sensata Technologies, Inc. ("Sensata") data sheets are solely intended to assist designers ("Buyers") who are developing systems that incorporate Sensata products (also referred to herein as "components"). Buyer understands and agrees that Buyer remains responsible for using its independent analysis, evaluation and judgment in designing Buyer's systems and products. Sensata data sheets have been created using standard laboratory conditions and engineering practices. Sensata has not conducted any testing other than that specifically described in the published documentation for a particular data sheet. Sensata may make corrections, enhancements, improvements and other changes to its data sheets or components without notice.

Buyers are authorized to use Sensata data sheets with the Sensata component(s) identified in each particular data sheet. HOWEVER, NO OTHER LICENSE, EXPRESS OR IMPLIED, BY ESTOPPEL OR OTHERWISE TO ANY OTHER SENSATA INTELLECTUAL PROPERTY RIGHT, AND NO LICENSE TO ANY THIRD PARTY TECHNOLOGY OR INTELLECTUAL PROPERTY RIGHT, IS GRANTED HEREIN. SENSATA DATA SHEETS ARE PROVIDED "AS IS". SENSATA MAKES NO WARRANTIES OR REPRESENTATIONS WITH REGARD TO THE DATA SHEETS OR USE OF THE DATA SHEETS, EXPRESS, IMPLIED OR STATUTORY, INCLUDING ACCURACY OR COMPLETENESS. SENSATA DISCLAIMS ANY WARRANTY OF TITLE AND ANY IMPLIED WARRANTIES OF MERCHANTABILITY, FITNESS FOR A PARTICULAR PURPOSE, QUIET ENJOYMENT, QUIET POSSESSION, AND NON-INFRINGEMENT OF ANY THIRD PARTY INTELLECTUAL PROPERTY RIGHTS WITH REGARD TO SENSATA DATA SHEETS OR USE THEREOF.

All products are sold subject to Sensata's terms and conditions of sale supplied at www.sensata.com SENSATA ASSUMES NO LIABILITY FOR APPLICATIONS ASSISTANCE OR THE DESIGN OF BUYERS' PRODUCTS. BUYER ACKNOWLEDGES AND AGREES THAT IT IS SOLELY RESPONSIBLE FOR COMPLIANCE WITH ALL LEGAL, REGULATORY AND SAFETY-RELATED REQUIREMENTS CONCERNING ITS PRODUCTS, AND ANY USE OF SENSATA COMPONENTS IN ITS APPLICATIONS, NOTWITHSTANDING ANY APPLICATIONS-RELATED INFORMATION OR SUPPORT THAT MAY BE PROVIDED BY SENSATA.

Mailing Address: Sensata Technologies, Inc., 529 Pleasant Street, Attleboro, MA 02703, USA.

CONTACT US

Americas

+1 (800) 350 2727
 sensors@sensata.com
 switches@sensata.com

Europe, Middle East & Africa

+359 (2) 809 1826
 pressure-info.eu@sensata.com

Asia Pacific

sales.isasia@list.sensata.com
 China +86 (21) 2306 1500
 Japan +81 (45) 277 7117
 Korea +82 (31) 601 2004
 India +91 (80) 67920890
 Rest of Asia +886 (2) 27602006
 ext 2808