



MORSETTIERA A VITE/FASTON 3 POLI KL100

SCREW TO TAB TERMINAL BLOCK WITH 3 POLES KL100



DATI TECNICI / TECHNICAL DATA

| | EUROPA | USA |
|---|---|----------|
| Sezione cavo / Cable section | 1,5 ÷ 6,0 mm ² | 18-8 AWG |
| Tensione nominale / Nominal Voltage | 450 V | 300 V |
| Corrente max / Max. Rating | 41 A | |
| Temp. d'esercizio / Working Temperature | T 150°C | T 130°C |
| Grado di protezione / Protection degree | IP 00 | |
| Corpo isolante / Plastic material | PA66 - GF25% - CLASS V-0 - GWT 750°C | |
| Numero poli / Number of poles | 3 | |
| Coppia di serraggio / Tightening torque | 0,5-1,0Nm (Max 2.5Nm) | |
| Dima di foratura / Cut out | Vedi disegno tecnico / Refer to technical drawing | |
| Parti metalliche / Metal parts | M6 zinc plated steel screw; 6,3X0,8 zinc plated steel tab insert; zinc plated steel grounding tab; Shunt insert made in copper (where assembled). | |

| Approvals | Standard References |
|--|---|
| VDE  | DIN EN 60998-1:2005-03; EN 60998-1:2004; DIN EN 60998-2-1: 2005-03; EN 60998-2-1:2004 DIN EN 61210 2011-06; EN 61210:2010 |
| UL CSA  | 1-UL Standard: UL 1059 Standard for terminal blocks Edition 4 Rev.Date 2011-10-14 2-Canadian Standard: CSA C22.2 NO.158-10 terminal blocks Edition 3-Issue Date 2010-03-01 |

PACKAGING

| Type | Poli / Poles | P-N | Pack. | Peso / Weight | Misure / Size |
|-------|--------------|--------------|---------|---------------|---------------|
| KL100 | 3 | 3MRN07001608 | 400 pz. | 14,31 Kg. | 300x400x270mm |

DISEGNO TECNICO / TECHNICAL DRAW

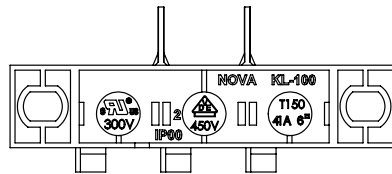
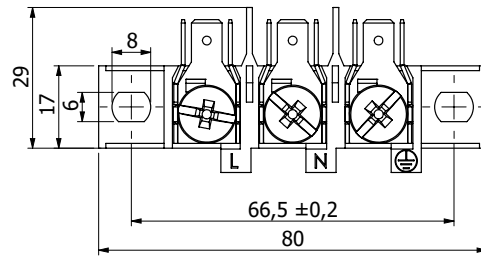
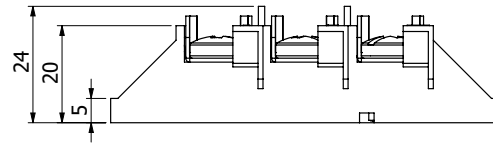

Panel Cut-Out

