



SXA4

TYPICAL APPLICATIONS	High pressure cleaners, ironing steam generators, industrial machines, cutters
FUNCTIONS	■ DPST, illuminated or not
PROTECTION DEGREE	IP 54, IP 55 for version with silicone
CYCLE No.	10.000
CUT OUT	30x22 mm
AMBIENT TEMPERATURE	125 °C
GWT	850 °C
GWT NO FLAME (<2sec)	750 °C on demand



S X A 4

?

?

DRAWING

TERMINAL

FUNCTION



O-RING

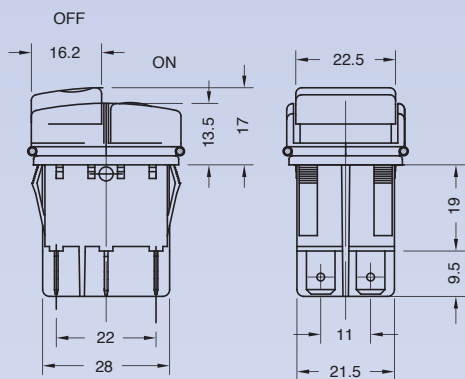

1 Standard

4 With silicone

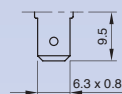

2

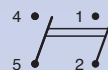

8

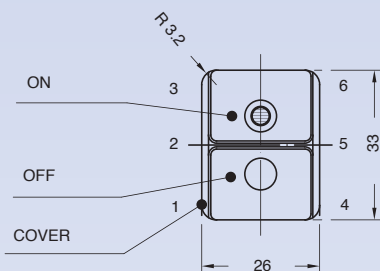
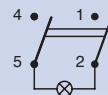

GASKET

3 Standard

5 With silicone

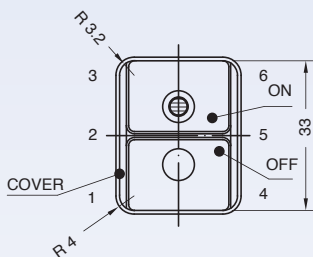
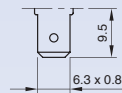
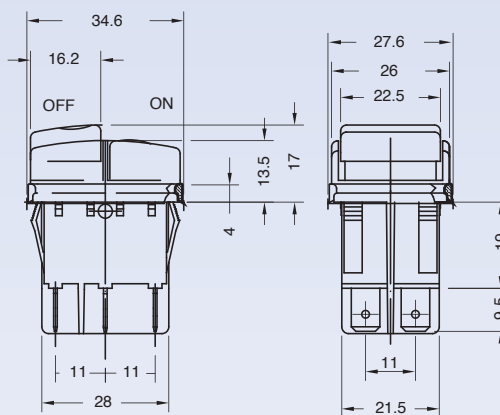

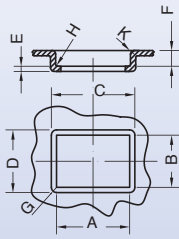
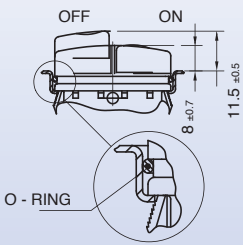

POS.	DIM.	TOL.
K	1.2	±0.1
H	R.0.6	+0.2
G	R.3.5	-0.1
F	5.5	+0.2
E	0.7/3.5	
D	26.6	±0.1
C	33.6	±0.1
B	22	+0.1
A	30	+0.2

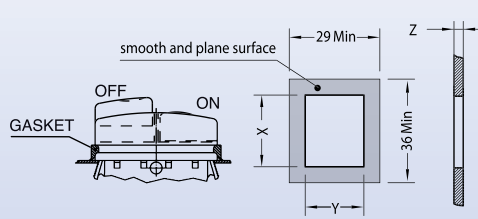

POS.	DIM.	TOL.
Z	0.7/3.5	
Y	22	+0.1
X	30	+0.2

TERMINAL	FUNCTION	RATING	FRAME COLOUR	BUTTON COLOUR ON	BUTTON COLOUR OFF	MARKING COLOUR ON	MARKING ON	MARKING OFF	LENS COLOUR		
S	X	A	4							0	0

RATING	FRAME COLOUR	BUTTON COLOUR	MARKING COLOUR	MARKING	LENS COLOUR
?	?	ON ? OFF ?	?	ON ? OFF ?	?

RATING

8

Function 2
 16 (8) A / 250 VAC
 10 (6) A / 250 VAC - 5E4
 10 (4) A / 400 VAC
 T125/55 °C
 EN 61058

16 A - 125 / 250 VAC
 3/4 HP - 125 / 250 VAC
 T105 °C
 UL 1054

Function 8
 16 (8) A / 250 VAC
 10 (6) A / 250 VAC - 5E4
 T125/55 °C
 EN 61058

16 A - 125 / 250 VAC
 3/4 HP - 125 / 250 VAC
 T105 °C
 UL 1054

9

Function 2 - 8
 12 (10) A / 250 VAC - 5E4
 T85 °C
 UL 1054

FRAME COLOUR

1 black

X **?** custom

BUTTON COLOUR

1 black

X **?** custom

MARKING COLOUR

0 none

2 white

X **?** custom

MARKING

Marking ON

0

2

3

5

X

Marking OFF

0

1

4

X

LENS COLOUR

0 none

ILLUMINATED

G red

L white

X **?** custom